

REV	REVISION	DATE
1	ADDED PRODUCT LOADING SPOUT, ALLIGNED COLUMN	12/06/06
0	FOR FINAL REVIEW/BUILDING PERMIT	06/05/06
C	DESIGN UPDATE	3/3/06

DATE:	12/05/05
DRAWN BY:	JEN
CHECKED BY:	
APPROVED BY:	
SCALE:	3/16"=1'-0"
FILE:	1524ME102
SIZE:	

JOB NAME	CITY OF STAMFORD CONNECTICUT SOLIDS DRYING PROJECT
TITLE	DRYER AREA
PROJECT NUMBER	1524
DRAWING NUMBER	ME-102
SHEET	1 OF 1

PLAN VIEW EL. 24.50'

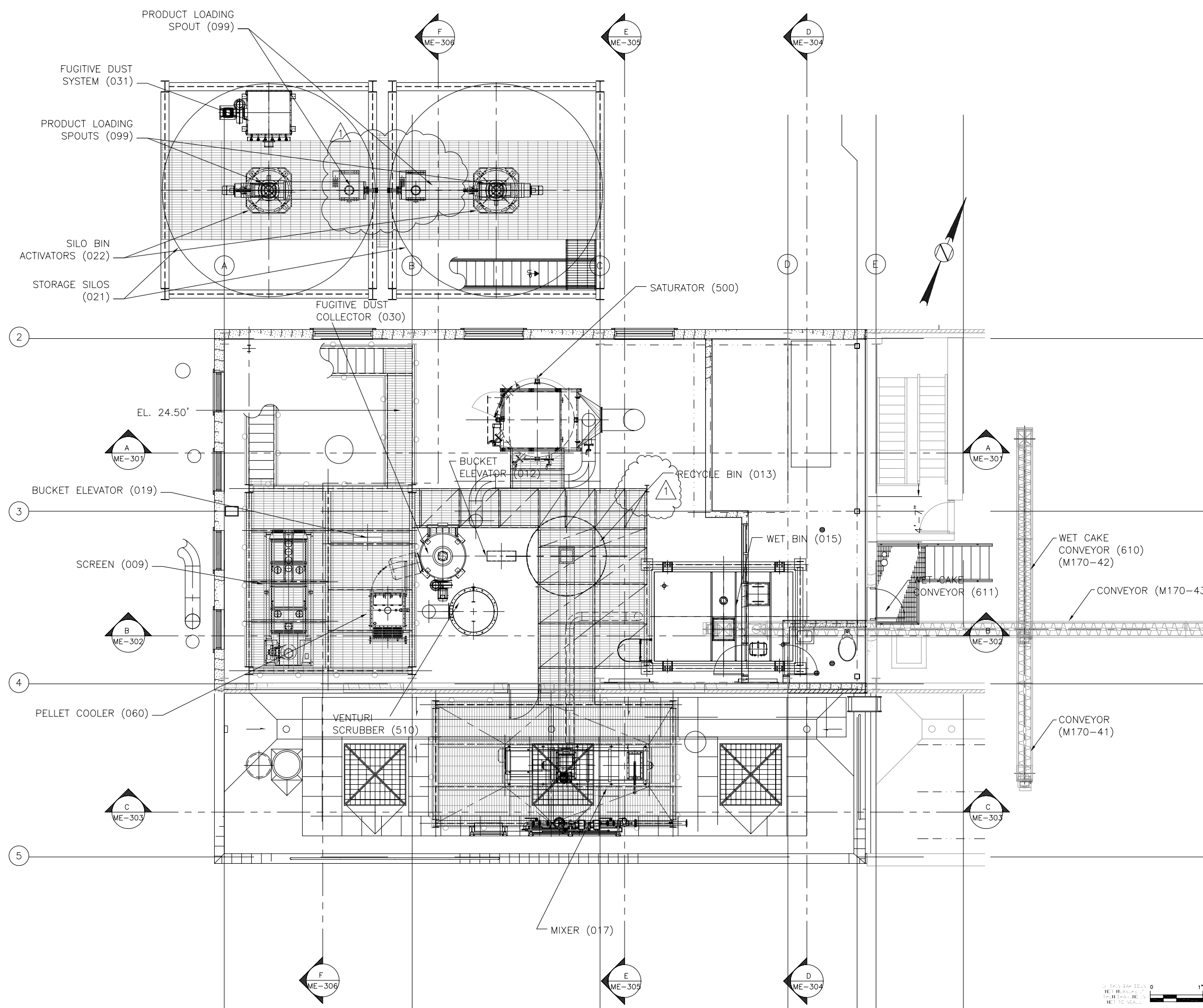

THIS DRAWING IS COPY RIGHTED
 FOR HIS PERSONAL USE WITHOUT THE SIGNED WRITTEN CONSENT OF ANDRITZ-RUTHNER, INC. IT MUST NOT BE COPIED NOR MADE AVAILABLE TO THIRD PARTIES. INCLUDING COMPETITORS, NOR MADE ACCESSIBLE TO SUCH PARTIES. ANY LEGAL USE BY THE RECEIVER OR THIRD PARTIES FOR WHICH HE IS RESPONSIBLE CAN CONSTITUTE A CAUSE FOR LEGAL ACTION. THIS DRAWING MUST BE RETURNED ON REQUEST OF THE COMPANY.

